



# PROMET VALVES AUSTRALIA

1A Green Road Woodville West SA 5011  
 www.prometvalves.com    promet@prometvalves.com  
 T: 08 8268 1777    ABN 47096 425 697    F: 08 8268 1711

## Resilient Seat PN10 Flanged Ball Check Valve (Table E)



Material List	
PART	MATERIAL
Body	Ductile Iron
Cover	Ductile Iron
Ball	Metal + EPDM
Gasket	EPDM

Specifications	
Cold Working Pressure	1000kPa
MAX Working Temperature	120°C
Flanges	AS2129 T/E
Face to Face	DIN3202

Applications - Water Treatment Plants

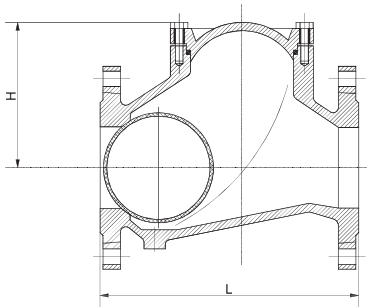

Resilient Seat PN10 Flanged Ball Check Valve (Table E)						
CODE	IMPERIAL SIZE	L	H	HOLE DIAMETER	NO. HOLES	APPROX. KG/PC
VFBC50	2	200	126	18	4	7.7
VFBC65	2 1/2	240	145	18	4	11.2
VFBC80	3	260	168	18	4	15.4
VFBC94	4	300	186	18	8	21.7
VFBC98	8	500	350	22	8	90
VFBCX25	10	600	443.7	22	8	163